

*Courses and Distances down
Creeks
Sugar & French, From the hard-
beam N° 1. S 19 W 86. W. O.*

- " 2 S 9 W 31.
- " 3 S 35 E 27.
- " 4 S 70 E 50
- " 5 N 84 E 72
- " 6 N 73 E 53. R. O.

C 177 - 144

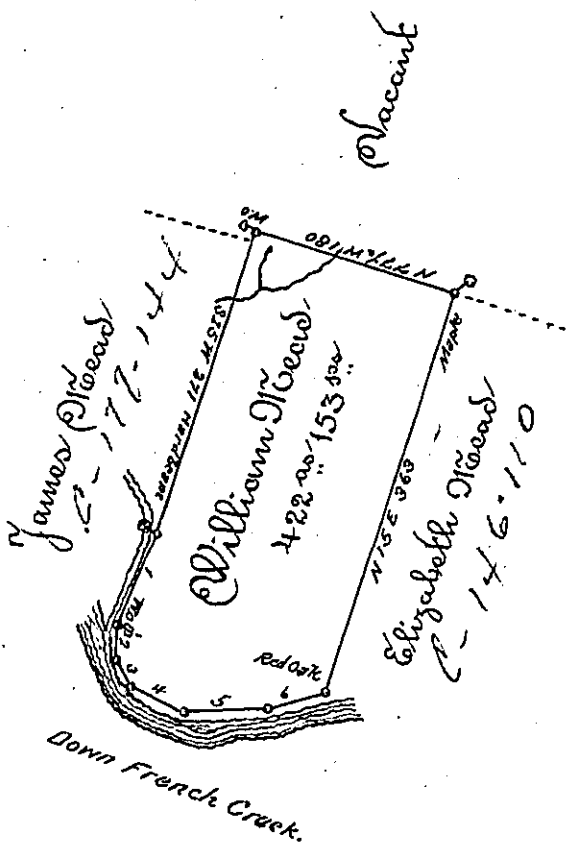

The above is the Draft of a Tract of Land in Sugar Creek Township, Venango County, on Sugar, and French Creeks, adjoining Lands of James Wead and Elizabeth Wead. Surveyed May 1st 1803. in pursuance of a Warrant granted to William Wead. bearing Date 1st Novich 1796.

To Samuel Cochran Esq.
Surveyor General.

Saml Dale Jr W. D.

IN TESTIMONY that the above is a copy of the original remaining on file in the Department of Internal Affairs of Pennsylvania, made conformably to an Act of Assembly approved the 16th day of February, 1833, I have hereunto set my Hand and caused the Seal of said Department to be affixed at Harrisburg, this

twentieth day of December 1894.

Geo. S. Steward
Secretary of Internal Affairs.